

DYNASET

POWERED BY HYDRAULICS

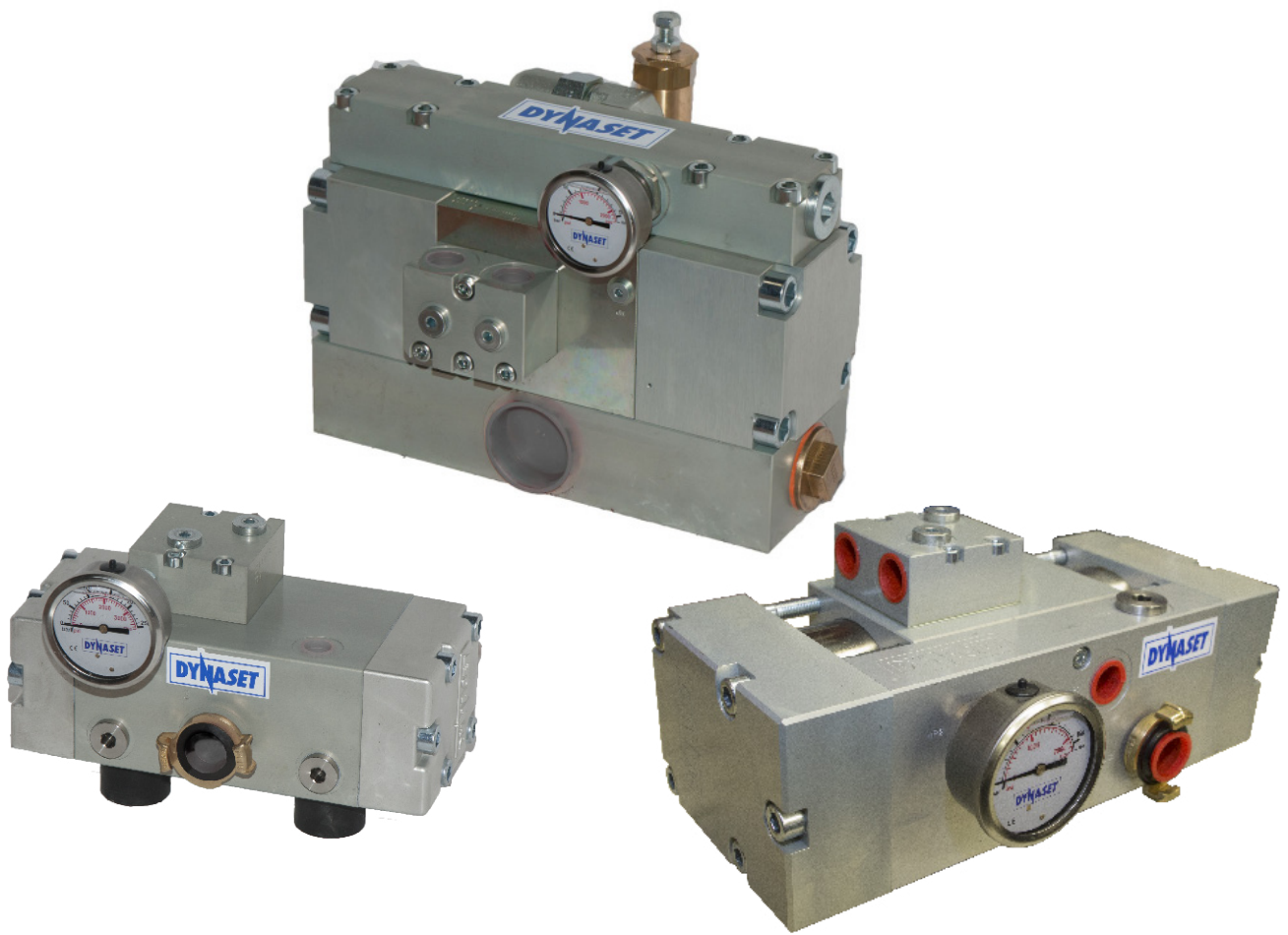

JMA
03/22
rev 1.3

DATA SHEET

HYDRAULIC DRILLING FLUID PUMP

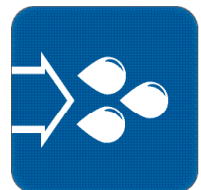

HDF 40 /40-8

HDF 90 /150-85

HDF 160 /70-90

HDF 180 /23-35

HDF 200 /40-55

HDF 250 /250-280

HYDRAULIC DRILLING FLUID PUMP

DYNASET HDF hydraulic drilling fluid pump transforms the hydraulic power of a work machine effectively into pumping power. Because of high pressure, the pump gives great pumping power with a small amount of pumping fluid. To ease up the use of the pump; pump is self-priming, requiring no feed pressure.

Small size, light weight, durable construction and low pumping fluid consumption make the HDW pump very cost effective. The patented design of the pump is completely free of rotating parts. Because of the compact size it can be installed practically in any space in the work machine. The power range of pumps available covers all needs.

DIMENSIONS

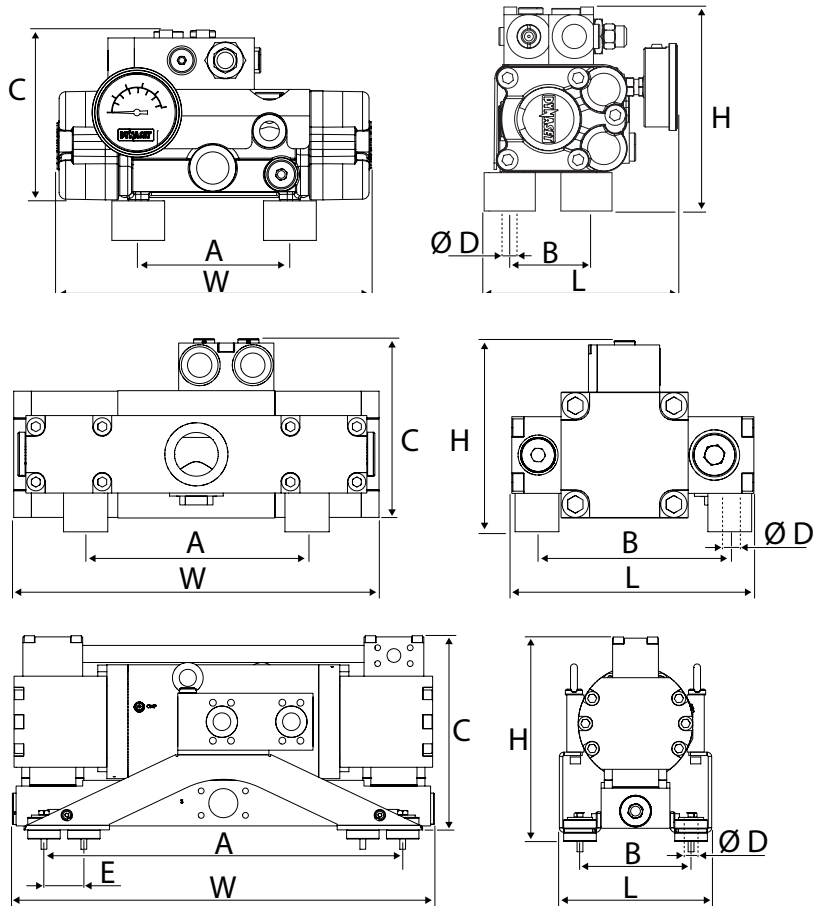

MODEL	DIMENSIONS, mm (in)								WEIGHT kg (lbs)
	L	W	H	A	B	C	D	E	
HDF 40 /40-8	190 (7.5)	315 (12.4)	170 (6.7)	90 (3.5)	80 (3.1)	140 (5.5)	M8	-	8 (17.6)
HDF 90 /150-85	175 (6.9)	345 (13.6)	250 (9.8)	252 (9.9)	95 (3.7)	250 (9.8)	M10	-	30 (66.1)
HDF 160 /70-90	220 (8.7)	330 (13.0)	180 (7.1)	200 (7.9)	175 (6.9)	160 (6.3)	M10	-	28 (61.7)
HDF 180 /23-35	160 (6.3)	245 (9.6)	165 (6.5)	135 (5.3)	60 (2.4)	135 (5.3)	M8	-	8 (17.6)
HDF 200 /40-55	170 (6.7)	280 (11.0)	185 (7.3)	126 (4.7)	106 (4.2)	153 (6.0)	M8	-	18 (39.6)
HDF 250 /250-280	270 (10.6)	745 (29.3)	360 (14.2)	630 (24.8)	194 (7.5)	340 (13.4)	16 (0.6)	70 (2.8)	170 (374.8)

PARAMETERS

		HDF 40 /40-8	HDF 180 /23-35	HDF 200 /40-55
DISCHARGE CHARACTERISTICS				
Pumping fluid flow max.	l/min (gal)	40 (10.6)	23 (6.1)	40 (10.6)
Pressure max.	bar (psi)	40 (580)	180 (2600)	200 (2900)
Power	kW	2,6	7	13
Fluid/hydraulic pressure ratio		0,2	1,18	1,26
HYDRAULIC POWER REQUIREMENTS				
Oil flow max.	l/min (gpm)	8 (2.1)	35 (9.3)	55 (14.5)
Operating pressure	Δp . bar (psi)	190 (2700)	190 (2700)	190 (2700)
Pressure max.	bar (psi)	210 (3000)		
PUMPING FLUID REQUIREMENTS				
Suction head max	m (ft)	3 (9.8)		
Feed pressure	bar (psi)	-0,3...16 (-4,3...232)		
Water filter	mesh	80 or better		
HYDRAULIC FLUID REQUIREMENTS				
Viscosity	cSt	10-200 / optimum 25-35		
Temperature *	° C (° F)	max. 70 (158)		
Filter ratio	μm	25 or better		
Cooling capacity requirement	kW	2	2	3

Gallons are U.S. liquid gallons

* Depending on hydraulic fluid.

		HDF 160 /70-90	HDF 90 /150-85	HDF 250 /250-280
DISCHARGE CHARACTERISTICS				
Pumping fluid flow max.	l/min (gal)	70 (18.5)	150 (39.6)	250 (66.0)
Pressure max.	bar (psi)	160 (2300)	90 (1300)	250 (3600)
Power	kW	19	23	85
Fluid/hydraulic pressure ratio		1,12	0,52	1,06
HYDRAULIC POWER REQUIREMENTS				
Oil flow max.	l/min (gpm)	90 (23.8)	85 (22.5)	280 (74.0)
Operating pressure	Δp . bar (psi)	180 (2600)	190 (2700)	190 (2700)
Pressure max.	bar (psi)	210 (3000)		
PUMPING FLUID REQUIREMENTS				
Suction head max	m (ft)	3 (9.8)		
Feed pressure	bar (psi)	-0,3...16 (-4,3...232)		
Water filter	mesh	80 or better		
HYDRAULIC FLUID REQUIREMENTS				
Viscosity	cSt	10-200 / optimum 25-35		
Temperature *	° C (° F)	max. 70 (158)		
Filter ratio	μm	25 or better		
Cooling capacity requirement	kW	6	4	20

Gallons are U.S. liquid gallons

* Depending on hydraulic fluid.

CONNECTION PORTS

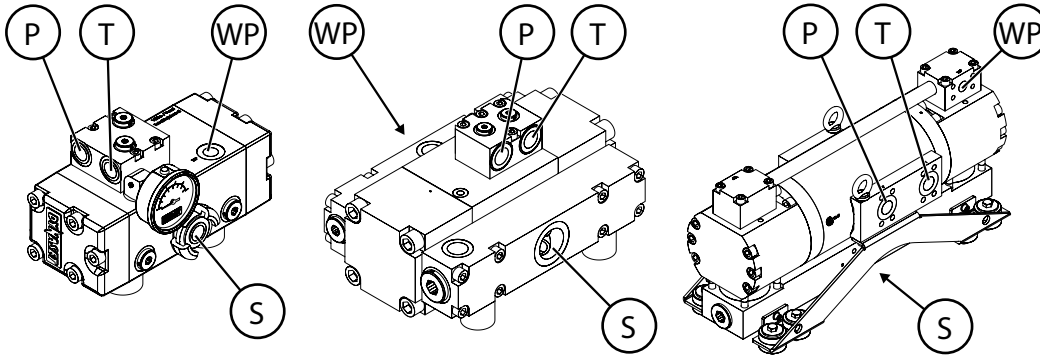

MODEL	PRESSURE LINE	RETURN LINE	SERVICE LINE	WATER OUTPUT	WATER INPUT
	P	T	CMP	WP	S
HDF 40 /40-8	BSP 1/2"	BSP 1/2"	-	BSP 1/2"	BSP 3/4"
HDF 90 /150-85	BSP 3/4"	BSP 3/4"	BSP1/8"	BSP 1"	BSP 2"
HDF 160 /70-90	BSP 3/4"	BSP 3/4"	BSP1/8"	BSP 3/4"	BSP 1 1/4"
HDF 180 /23-35	BSP 1/2"	BSP 1/2"	-	BSP 3/8"	BSP 3/4"
HDF 200 /40-55	BSP 3/4"	BSP 3/4"	-	BSP 1/2"	BSP 1"
HDF 250 /250-280	SAE 6000 1 1/4"	SAE 6000 1 1/4"	BSP1/8"	SAE 6000 1" (BSP 3/4")	SAE 3000 2"



HYDRAULIC DRILLING FLUID PUMP

DATA SHEET



Menotie 3
FI-33470 Ylöjärvi, Finland
tel: +358 3 3488 200
info@dynaset.com



ELECTRICITY

HG Hydraulic Generator
HGV POWER BOX Variable Hydraulic Generator System
HGV Variable Hydraulic Generator System
HWG Hydraulic Welding Generator
HGG Hydraulic Ground Power Generator



HIGH PRESSURE WATER

HPW Hydraulic High Pressure Water Pump
HPW Hydraulic Power Washer
KPL High Pressure Street Washing Unit
HPW-DUST High Pressure Dust Suppression System
PPL High Pressure Pipe Cleaning Unit
HDF Hydraulic Drilling Fluid Pump
HPW-FIRE High Pressure Firefighting System
FP Firefighting Piercing Kit
JPL High Pressure Bin Washing System
HSP Hydraulic Submersible Pump



COMPRESSED AIR

HK Hydraulic Piston Compressor
HKR Hydraulic Screw Compressor
HKL Hydraulic Rotary Vane Compressor



VACUUM

HCF Hydraulic Centrifugal Fan
HRVB Hydraulic Recycling Vacuum Bucket



MAGNET POWER

HMG PRO Hydraulic Magnet Generator
MAG Lifting Magnet
HMAG PRO Hydraulic Magnet



VIBRATION

HVB Hydraulic Vibra
HVD Hydraulic Directional Vibra
HRC Hydraulic Reversal Cylinder



POWER BOOSTING

HPI Hydraulic Pressure Intensifier
HPIC Hydraulic Pressure Intensifier for Cylinder



KNOW-HOW

Hydraulic Power Take-off (PTO)
Installation Valves
HMV Hydraulic Modular Valve System
HHK Hydraulic Grinder
HV Hydraulic Winch & HVY Hydraulic Winch Unit
De-Icing Technology
HEU Hydraulic Expansion Unit
HPU Hydraulic Power Unit
HRU Hydraulic Rescue Unit

www.dynaset.com

